

RG-402 Blue Outer Jacket
Formable Cable Assembly
Hand bend to final shape

Part Number	Connector Type	Cable Length
P1-SMAP/SMAPRA-141CJ-XX	SMA Stainless Steel Coupling Nut (passivated), Au-plated Brass Body	XX = Length
RG402 formable, OD=0.163" Nominal, Blue Jacket		

- * 100% "go/no-go" VSWR test to 10 GHz
- * 100% Hi-POT tested, Voltage = 500 volts
- * Choose your length: 3" - 96"
- * Labeling = Part Number and Date Code
- * Custom Requirements Welcome
- * RoHS compliant

Length Tolerance

L (inches)	Tolerance (inches)
3 - 5.9	± 0.125
6 - 11.9	± 0.187
12 - 23.9	± 0.250
24 - 35.9	± 0.313
> 36	contact P1dB

10 GHz RF Specifications @ 25 C°

- * VSWR: Max. 1.35 : 1
- * Insertion Loss (dB): Typical $0.4 + 0.045 * \text{Length (in inches)}$

SMA Male

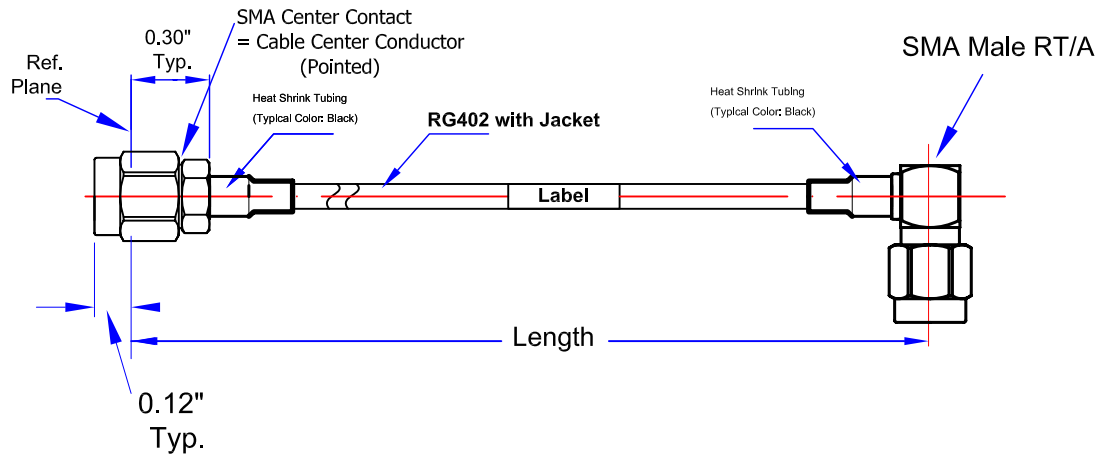
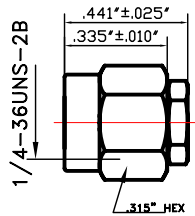

SMA Male RT/A

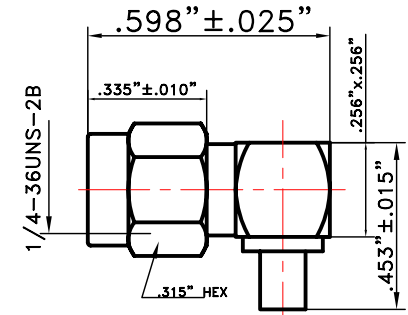

Contact :
P1dB
EXCLUSIVE DISTRIBUTOR
 RFMW, LTD.
 San Jose, CA
sales@RFMW.com
 Tel: (877) 367-7369

		SIZE A	SCALE NO	UNLESS OTHERWISE SPECIFIED TOLERANCES: .XX = .XXX = DIMENSIONS ARE IN INCHES	P1dB
		REV. B	SHEET 1/1		
DRAWING BY: Z. Lou	DATE: 9/28/2009	PART NO.		TITLE	SMA Male Straight-Right Angle Cable Assembly
CHECKED BY: S. Ulett	DATE: 9/28/2009	SEE ABOVE			
APPROVED BY: S. Ulett	DATE: 9/28/2009				