

Precision Stainless Steel SMA to SMA Adapters

Mix and Match for the same low price \$9.95 ea

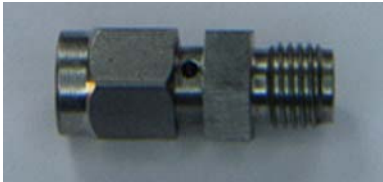

SMA Male to SMA Female Adaptor with 0.315" HEX
PART NO.: P1-ADP-SMAPSS/SMAJSS-HEX

Connector
Saver

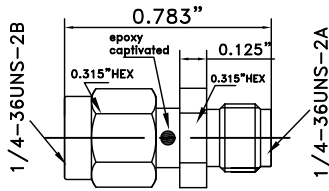

SMA Male to SMA Female Adaptor
PART NO.: P1-ADP-SMAPSS/SMAJSS

Connector
Saver

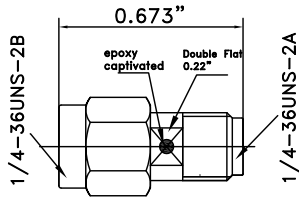

SMA Female to SMA Female Adaptor with 0.315" HEX
PART NO.: P1-ADP-SMAJSS/SMAJSS-HEX

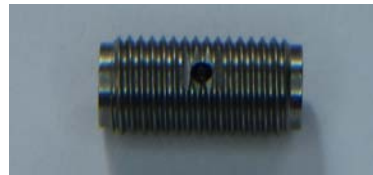
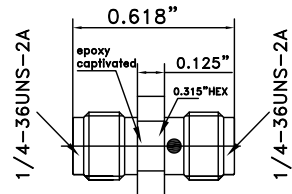

SMA Female to SMA Female Adaptor
PART NO.: P1-ADP-SMAJSS/SMAJSS

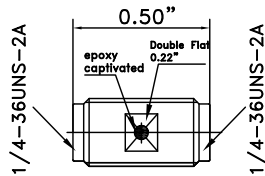

SMA Male to SMA Male Adaptor
PART NO.: P1-ADP-SMAPSS/SMAPSS

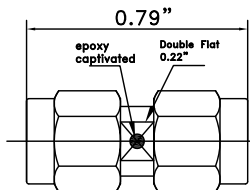

Materials and Finish		
Item	Materials	Finish
Connector Body	Stainless Steel	Passivated
Center Conductor	Beryllium Copper	Gold over Nickel
Captivation	Epoxy	None

Electrical (Typical)

- * Impedance: 50 Ohms
- * Frequency Range: DC - 18 GHz
- * VSWR: 1.20 : 1 (Max) for DC - 18 GHz
- * Operating Temp. Range: -65 °C - +125 °C

Mechanical (Typical)

- * Connector: Mates with MIL-STD-348

RoHS Compliant: YES



P1dB

To order contact:

RFMW, LTD.
San Jose, CA
Tel: (408) 414 - 1450 or (877) 367 - 7369
Email: sales@RFMW.com
Web: www.rfmw.com
www.p1db.com