

REV.	DESCRIPTION	ECO	DATE	APPROVED
A	INITIAL RELEASE		02/01/10	P.T.
B	CHANGE PEAK POWER TO 750W		02/02/10	P.T.

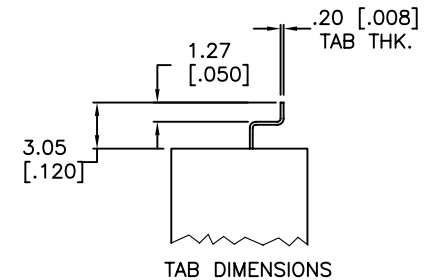
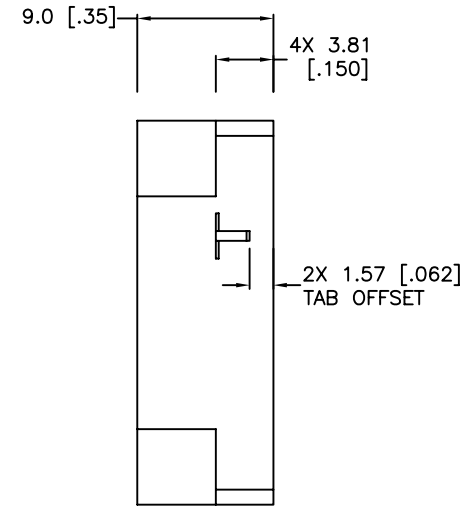
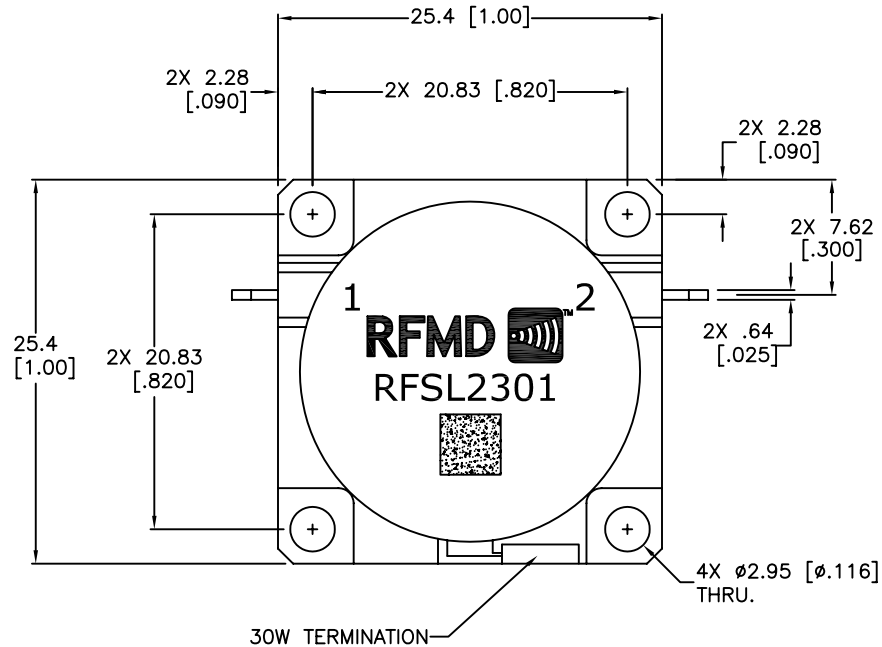

Specifications

Parameter	Minimum	Typical	Maximum
Frequency Range (MHz)	1200		1400
Insertion Loss (dB)		< .25	.30
Isolation (dB)	20	> 23	
Return Loss (dB)	20	> 23	

Power & Temperature Ratings

Parameter	Maximum
Forward PWR Peak/AVG	750/200 Watts
Reverse Power	30 Watts
Operating Temperature	-40 to +85° C
Storage Temperature	-40 to +95° C

ISOLATOR MODEL: RFSL2301

- Notes:
1. Typical Values Represent Mid-Band Performance @ +23 °C.
 2. All Material And Plating Are RoHS Compliant.

UNLESS OTHERWISE SPECIFIED DIMENSIONS ARE IN MM [INCHES], TOLERANCES ARE:
 FRACTIONS DECIMALS ANGLES
 ± .X± .3 [.01] ±0.5°
 ± .XX± .13 [.005]

MATERIAL
 FINISH
 HOUSING: ELECTROLESS NICKEL
 CIRCUIT TAB: SILVER

APPROVALS		DATE
DRAWN	P.T.	02/01/10
ENG.	P.T.	02/01/10
MKT./SALES	.	.
BUS MGR.	.	.



OUTLINE DRAWING

SIZE	SCALE	DWG.	REV.
A	2X	200-00280	B
DO NOT SCALE DRAWING			SHEET 1 OF 1