

# ATTENUATORS

TNC up to 6 GHz, 100 Watts

## SPECIFICATIONS:

Models: XT100W-XX, XT100W-XXF, XT100W-XXM

**RoHS**  
Compliant

**AEROFLEX**  
A passion for performance.

### Electrical:

Frequency Range \_\_\_\_\_ DC - 6.0 GHz  
Standard Freq. Values \_\_\_\_\_ 1.5, 2.5, & 6 GHz  
Standard dB Values \_\_\_\_\_ 3, 6, 10, 20, 30 & 40 dB  
Attenuation Accuracy DC - 1.5 GHz 1.5 - 2.5 GHz 2.5 - 6 GHz  
1 - 6 dB \_\_\_\_\_  $\pm 0.50$  dB \_\_\_\_\_  $\pm 0.50$  dB \_\_\_\_\_  $\pm 0.75$  dB  
10 - 40 dB \_\_\_\_\_  $\pm 0.75$  dB \_\_\_\_\_  $\pm 1.0$  dB \_\_\_\_\_  $\pm 1.5$  dB  
VSWR (Max.) \_\_\_\_\_ 1.20:1 \_\_\_\_\_ 1.30:1 \_\_\_\_\_ 1.40:1  
Input Power \_\_\_\_\_ 100 Watts Avg.  
Derated Linearly to 20 Watts @ +125°C  
Reverse Power \_\_\_\_\_ 20 Watts Max.  
Peak Power \_\_\_\_\_ 1 kW Max.  
(5uSec Pulse, .05% Duty Cycle)  
Impedance \_\_\_\_\_ 50 Ohms  
Operating Temp Range \_\_\_\_\_ -55°C to +125°C

### Mechanical:

TNC Connectors \_\_\_\_\_ Passivated Stainless Steel  
Mates with MIL-STD-348  
Conductors \_\_\_\_\_ Gold Plated Beryllium Copper  
Housing \_\_\_\_\_ Anodized Aluminum

Custom Mtg. hole Config.  
may be Added to this  
Surface

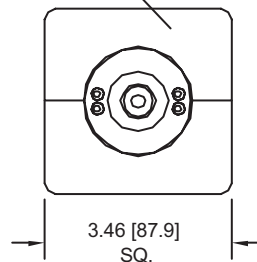

**END VIEW  
TYPICAL**

Units must be Mounted in such a way as to  
Allow for Free Air Flow Around fins to Assure  
Performance

Note: Units are Unidirectional, Therefore Input Connector MUST be specified & will be Indicated on Unit

Model Number: **XT100W-XX**  
Male/Female Connectors  
Length: 6.53  $\pm$  .05 [165.9  $\pm$  1.3]  
Pictured

Model Number: **XT100W-XXF**  
Female/Female Connectors  
Length: 6.62  $\pm$  .05 [168.1  $\pm$  1.3]

Model Number: **XT100W-XXM**  
Male/Male Connectors  
Length: 6.43  $\pm$  .05 [163.3  $\pm$  1.3]

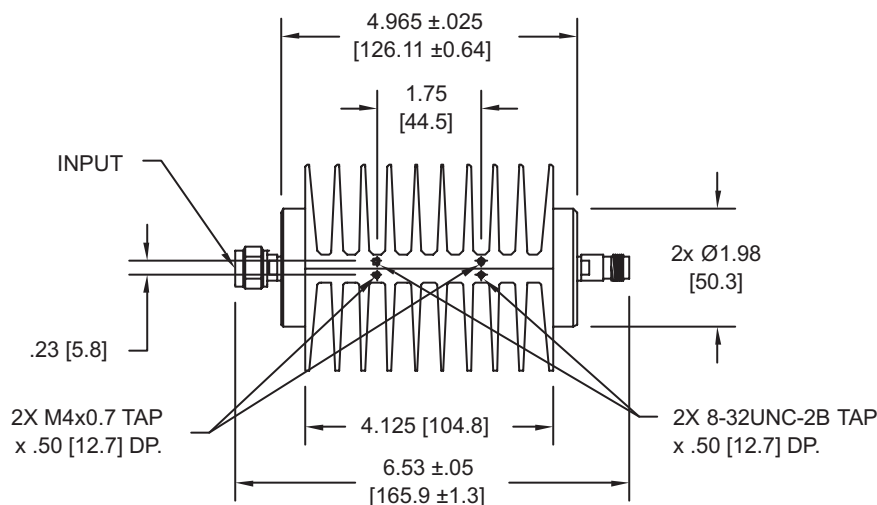

## HOW TO ORDER:

Model Number: **XT100W-XXY**

Freq. Range  
1 = DC - 1.5 GHz  
2 = DC - 2.5 GHz  
6 = DC - 6 GHz

Connector Configuration  
= Male/Female  
(Male Input)  
F = Fem/Fem  
M = Male/Male  
FM = Female/Male  
(Female Input)  
dB Value

### Ordering Examples:

Model Number: **1T100W-1**  
DC - 1.5 GHz, 1 dB; TNC - Male/Fem

Model Number: **2T100W-3F**  
DC - 2.5 GHz, 3 dB; TNC - Fem/Fem

Model Number: **6T100W-20FM**  
DC - 6 GHz, 20 dB; TNC - Female/Male

Note: Dimensions in Brackets are Expressed in Millimeters and are for Reference Only.  
Design, specifications are subject to change without notice. Contact factory for technical  
specifications before purchasing or use.

XT100W-ATT: REV N

**AEROFLEX**  
INMET

Aeroflex / Inmet, Inc. • 300 Dino Drive, Ann Arbor, MI 48103 • U.S.A.  
888-244-6638 or 734-426-5553 • FAX: 734-426-5557  
www.aeroflex-inmet.com • sales@aeroflex-inmet.com