

# SPECIFICATIONS

## ELECTRICAL

FREQUENCY RANGE \_\_\_\_\_ DC - 6 GHz

### ATTENUATION ACCURACY

0 - 6 dB \_\_\_\_\_ ±0.30 dB  
7 - 20 dB \_\_\_\_\_ ±0.50 dB  
21 - 30 dB \_\_\_\_\_ ±0.75 dB

### VSWR

DC - 2.5 GHz \_\_\_\_\_ 1.15:1 MAX  
2.5 - 6 GHz \_\_\_\_\_  
0 - 6dB \_\_\_\_\_ 1.20:1 MAX  
7 - 12dB \_\_\_\_\_ 1.25:1 MAX  
13 - 20dB \_\_\_\_\_ 1.30:1 MAX  
25 - 30dB \_\_\_\_\_ 1.35:1 MAX

INPUT POWER \_\_\_\_\_ 2 WATTS AVG. @ 25°C  
DERATES LINEARLY TO 10% @ 125°C FROM 25°C

PEAK POWER \_\_\_\_\_ 200 WATTS  
(5µSec PULSE WIDTH, 0.01% DUTY CYCLE)

IMPEDANCE \_\_\_\_\_ 50 OHMS

OPERATING TEMP RANGE \_\_\_\_\_ -65°C TO +125°C

CONFORMANCE TESTING IS 100% ATTENUATION AND V.S.W.R.  
ACROSS FULL, FREQUENCY RANGE AT 20-25°C

## MECHANICAL

CONNECTOR BODIES \_\_\_\_\_ PASSIVATED STAINLESS STEEL  
CENTER CONDUCTORS \_\_\_\_\_ GOLD PLATED BERYLLIUM COPPER  
INSULATORS \_\_\_\_\_ PTFE (TEFLON) IAW ASTM-D1710  
RESISTIVE ELEMENT \_\_\_\_\_ THIN FILM ON CERAMIC RESISTIVE CIRCUIT  
NOT A HERMETIC SEALED UNIT  
RECOMMENDED MATING TORQUE IS 7-8 in./Lbs. (0.8 to 0.9 Nm)

## MARKING

PART LOOKS LIKE PRODUCT IMAGE ABOVE.  
PART MARKING ORIENTATION AND FORMAT AS SHOWN.  
REPLACE XX WITH APPROPRIATE TWO DIGIT dB VALUE.  
MARKING TO BE AS LARGE AS POSSIBLE, CLEAR, READABLE.  
YYWW EQUALS DATE CODE.

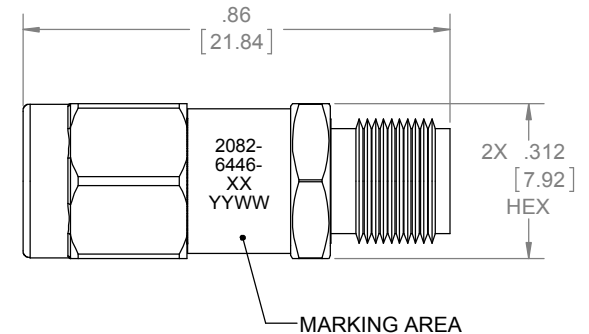
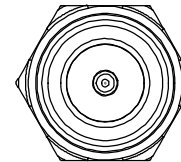
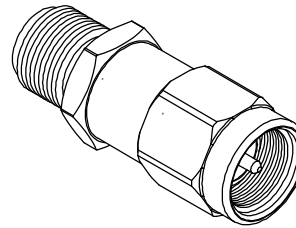

REVISIONS				
REV	DESCRIPTION	ECO #	DATE	APPROVED
C	REDRAWN IN SOLIDWORKS	14-296	8/20/14	T.KUHN

QTY.	PART NUMBER	DESCRIPTION	ITEM NO.
X	2082-6446-dB	ATTENUATOR, SMA-m/f, DC -6 GHz, 2 WATT	
1	TA-2082-6446-dBU	ASSY, ATTENUATOR, SMA-m/f, DC -6 GHz, 2 WATT, UNMARKED	1

DRAWING PRACTICES PER ANSI-Y-14.5 MIL-STD-100 & 1000
DIMENSIONS ARE IN INCHES AND APPLY BEFORE / AFTER PROCESSING
SURFACE ROUGHNESS µINCHES
FINISH: 63
SEE NOTE
MATERIAL:
SEE NOTE
NOTE: THIS DRAWING INCORPORATES THIRD ANGLE PROJECTION.
INTERPRET IAW ANSI Y14.5-1982

UNLESS OTHERWISE SPECIFIED TOLERANCES IN:
DECIMALS INCH (MM)
.X" .05" [1.27]
.XX" .03" [.76]
.XXX" .010" [.25]
ANGLES ±0°30'
REMOVE ALL BURRS/SHARP W/ BREAK / R OF .003" TO .0005"
UNLESS OTHERWISE NOTED DIAS CONCENTRIC <.003 T.I.R.
DO NOT SCALE PRINT

DRAWN SAUNDERS	DATE 1/1/07
CHECKED	DATE 1/1/07
ENG. APPR. SAUNDERS	DATE
THESE DRAWINGS AND SPECIFICATIONS ARE THE PROPERTY OF XMA CORP. OR OMNI SPECTRA AND SHALL NOT BE REPRODUCED, COPIED NOR USED - IN WHOLE OR IN PART - AS A BASIS FOR THE MANUFACTURE OR SALE OF OTHER ITEMS WITHOUT THE EXPRESS WRITTEN PERMISSION OF XMA CORP.	



Phone: 603-222-2256 Fax: 603-222-2259  
150 Dow Street, Manchester, NH 03101

ATTENUATOR, SMA-m/f, DC -6 GHz, 2 WATT

SIZE	CAGE CODE	DRAWING NUMBER	REV
B	3HT76	2082-6446-dB	C
SCALE	PLATED AREA SQ. IN	SHEET 1 OF 1	